

# Research Training Associate in Japanese Studies (Fixed Term)

Faculty of Asian and Middle Eastern Studies

Closing Date: 17th January 2025  
Job Reference: GX43378



# Research Training Associate

**Salary:**

£36,024—£44,263

**Contract:**

Fixed term—3 years

**Location:**

Central Cambridge

**Department:**

Department of East Asian  
Studies

**Working pattern:**

Full time

**Purpose of the role**

The Department of East Asian Studies, within the Faculty of Asian and Middle Eastern Studies at the University of Cambridge, seeks to appoint to a 3-year, fixed-term Postdoctoral Research Training Associate in Japanese Studies. The post will start in September 2025 and last until August 2028. This position is designed for early career researchers and provides mentoring and training in teaching and research to enhance the role holders future career prospects.

We are open to any specialty within the range of fields from premodern to modern Japanese Studies with an expectation of fluency in Japanese, which may include classical Japanese and/or *kanbun*. We also welcome applications from candidates who embody our “Japan and the World” campaign and with an interest in comparative studies in relation to the rest of East Asia.

Appointees will be expected to engage in high-level research, to publish in their specialist field, and to contribute to teaching, supervising and the examination of undergraduates and as required Masters students. An academic mentor will be assigned to the appointee to provide guidance and advice on each aspect of their development.

A capstone of the research output will be the organisation of a workshop at an approved time late in the second year or early in the third year during which the candidate will (with a separate budget from the Japan Studies section) invite scholars to a round table to discuss the candidate’s planned book manuscript or significant peer reviewed article with an aim for publication.

Some research money will be available for research expenses and conference attendance throughout the 3 years of this post.

Training in curriculum development, conference organising, running seminars, and supervising students will form part of the role.

Given the wide remit of the research conducted by the Japanese Studies group, the awardee will have the opportunity to receive further training through joining research groups and international conferences and thus expand their skill sets in areas outside of research and teaching but which remain central to the pursuit of academic excellence. This element is also particularly exciting because most members in the Japanese studies group are interested in Japan and its relations to its geographic neighbors in the region. For a full profile of the section and the current projects the various instructors are engaged in, please see: <https://www.ames.cam.ac.uk/research/research-region/east-asia/japan>

# Research Training Associate

## Key Responsibilities

### 1. Research and scholarship:

- Under the guidance of an academic mentor, develop research objectives and proposals for own research for the duration of the contract;
- conduct individual and collaborative research projects;
- write up research work for presentation and publication;
- continually update knowledge and understanding in field or special focus;
- undertake training relating to a wide range of aspects of academic roles provided within the Faculty and the wider University;
- translate knowledge of advances in the subject areas into research activity;
- manage own research and administrative activities, with guidance if required;
- assist in the preparation of proposals and applications to external bodies, e.g. for funding and contractual purposes;
- communicate material of a specialist or highly technical nature.

### 2. Teaching and organizational responsibilities will include:

- contributing to undergraduate and graduate courses;
- supervising undergraduate and MPhil projects;
- examining undergraduate and MPhil students;
- undertake training relating to a wide range of aspects of academic roles provided within the Faculty and the wider University;
- receiving feedback and guidance from the academic mentor.

### 3. Liaison and networking:

- liaise with colleagues and students;
- build internal and external contacts and participate in networks for the exchange of information and to form relationships for future collaboration.

# Person specification

Essential      Desirable

## Education

Hold a PhD in a relevant specialist subject or submitted their thesis and had their viva (if necessary) by the time they arrive at Cambridge for the start of the position.

✓

## Specialist Knowledge and Skills

A thorough knowledge of the Japanese language

✓

Demonstrable experience of managing own workload

✓

Confident communicator (oral and written)

✓

Flexible attitude and able to show initiative

✓

Team worker

✓

## Interpersonal & communication skills

Patient and diplomatic, able to work under pressure

✓

Comfortable dealing with people from all cultures and backgrounds

✓

Proficiency in using up-to-date communications media (online teaching platforms; websites; social media, etc.)

✓

Travel nationally and internationally when needed

✓

## Relevant Experience

Possesses depth and breadth in knowledge that could be turned into teachable materials

✓

Possess some research experience, although still being at an early stage of their career, with sufficient breadth/depth of specialist knowledge in the discipline and of research methods and techniques to design and execute a research project beyond the PhD

✓

Continually update knowledge in the specialist area and engage in continuous professional development.

✓

Evidence of high-quality research outputs, including publication in leading journals and conferences in the field

✓

# Professional Services Values

Developed by professional services staff, our values underpin everything we do. By living the values in the work we do, we hope to foster an environment where staff feel empowered. The values encourage staff to; work together and share skills to create a sense of community, act with integrity, take an inclusive and fair approach and develop honest and open relationships that are underpinned by our shared values. We encourage applicants to consider these values within their application.



## The Faculty of Asian and Middle Eastern Studies

The Faculty of Asian and Middle Eastern Studies combines world class scholarship with a vibrant teaching and learning environment for undergraduates and postgraduate students. Our academics are engaged in internationally recognized scholarship on the histories, literatures, linguistics, social anthropology, religion, politics, and contemporary cultures of the Middle East, North Africa, China, Japan, and the two Koreas. The work of several staff crosses traditional geographic and subject boundaries. All our work is firmly grounded in primary source research. The Faculty maintains a close relationship with various Research Institutes across the University. The Faculty combines excellence in teaching, academic rigour and research with a strong tradition of support for its students. In Cambridge, most students identify more with their colleges than with their university department. The opposite is the case for our students. The Faculty Library, with 70,000 monographs, nearly 2,000 DVDs, and a wide range of journal subscriptions, is a key and comfortable facility, to which graduate students have 24 hour access.

The Faculty consists of two departments: the Department of East Asian Studies and the Department of Middle Eastern Studies. It is home to the Centre of Islamic Studies, which promotes a critical understanding of Islam and Muslims in wider society. The Faculty's work is overseen by a Faculty Board, to which a range of committees report, while financially it is underpinned by several significant trust funds.

# The School of Arts and Humanities



The School of Arts and Humanities is one of six schools in the University and it is currently comprised of:

- Faculty of Asian and Middle Eastern Studies
- Faculty of Architecture and History of Art
- Faculty of Classics
- Faculty of Divinity
- Faculty of English
- Faculty of Modern and Medieval Languages and Linguistics
- Faculty of Music
- Faculty of Philosophy
- Centre for Research in the Arts, Social Sciences and Humanities
- Cambridge Digital Humanities
- University of Cambridge Language Centre
- Institute for Technology and Humanity

Combined, these institutions have a total annual budget in excess of £45million, 700 staff and 3,500 students.

The School has recently agreed a new strategic plan, which sets out its overarching vision and objectives.

## Vision

The Strategic Vision of the School of Arts and Humanities is to retain its position in the world top five. We see this not as a simple metric but as a challenge for which we must foster a culture and practice of openness: to countries and traditions around the globe, to major themes, to new ways of teaching, to diversity in our student intake and staff recruitment, to inclusiveness in our career development, and to the breaking down of structures that prevent us achieving the ambitious goals we set ourselves.

# Terms of appointment

## Tenure and probation

Appointments will be made on a fixed-term basis for a period of 3 years, from the 1st September 2025—30 August 2028, due to the post being a traineeship . Appointments will be subject to satisfactory completion of a six month probationary period.

## Hours of Work and Working Pattern

The hours of work for the position are 37 hours per week, working Monday – Friday. We welcome applications from individuals who wish to be considered for part-time working or other flexible working arrangements.

## Pension

You will automatically be enrolled to become a member of USS (Universities Superannuation Scheme) – a defined benefits pension scheme. For further information please visit:

[www.pensions.admin.cam.ac.uk](http://www.pensions.admin.cam.ac.uk)

## Annual leave

Full time employees are entitled to annual paid leave of 41 days inclusive of public holidays. For new part-time employees, annual leave will be pro rata'd based on days worked.

## General information

### Pre-employment checks

### Right to work in the UK

We have a legal responsibility to ensure that you have the right to

work in the UK before you can start working for us. If you do not have the right to work in the UK already, any offer of employment we make to you will be conditional upon you gaining it.

### Health declaration

Once an offer of employment has been made the successful candidate will be required to complete a work health declaration form.

### Qualifications

The person specification for this position lists qualifications that are essential and/or desirable. Please note that if you are offered the post you will be asked to provide your relevant original certificates of these qualifications.

### References

Offers of appointment will be subject to the receipt of satisfactory references.

### Information if you have a disability

The University welcomes applications from individuals with disabilities.

We are committed to ensuring fair treatment throughout the recruitment process. We will make adjustments to enable applicants to compete to the best of their ability wherever it is reasonable to do so and, if successful, to assist them during their employment. Information for disabled

applicants is available at <http://www.admin.cam.ac.uk/offices/hr/staff/disabled/>

We encourage you to declare any disability that you may have, and any reasonable adjustments that you may require, in the section provided for this purpose in the application form. This will enable us to accommodate your needs throughout the process as required. However, applicants and employees may declare a disability at any time.

If you prefer to discuss any special arrangements connected with a disability, please contact, the School HR Team ([sahhr@admin.cam.ac.uk](mailto:sahhr@admin.cam.ac.uk)) who are responsible for recruitment to this position.

# The University

**The University of Cambridge is one of the world's oldest and most successful universities. We are a renowned centre for research, education, and scholarship that makes a significant contribution to society. The University is consistently ranked amongst the top universities in the world. Our affiliates have won more Nobel Prizes than any other University.**

Our sustained pursuit of academic excellence is built on a long history of world-leading teaching and research within a distinctive collegiate system. For eight centuries our ideas and innovations have shaped the world. Our principal goal is to remain one of the world's leading universities in an increasingly competitive global higher education sector. Today the University of Cambridge is at the centre of a cluster of over 4,300 businesses employing 58,000 people.

Our capital investment projects include academic and commercial growth at both the West Cambridge Innovation District, and the Biomedical Campus in the south of the city. Eddington, in North West Cambridge, is a mixed-use development including key worker housing for staff, a community centre and a new primary school, managed by the University. Through these projects, the University is deeply embedded in, and committed to serving, our local community. These are all conspicuous signs of a University that is not only adapting to new needs, but also anticipating the future.

Our mission is to contribute to society through the pursuit of education, learning, and research at the highest international levels of excellence. Our core values are:

- freedom of thought and expression; and
- freedom from discrimination.

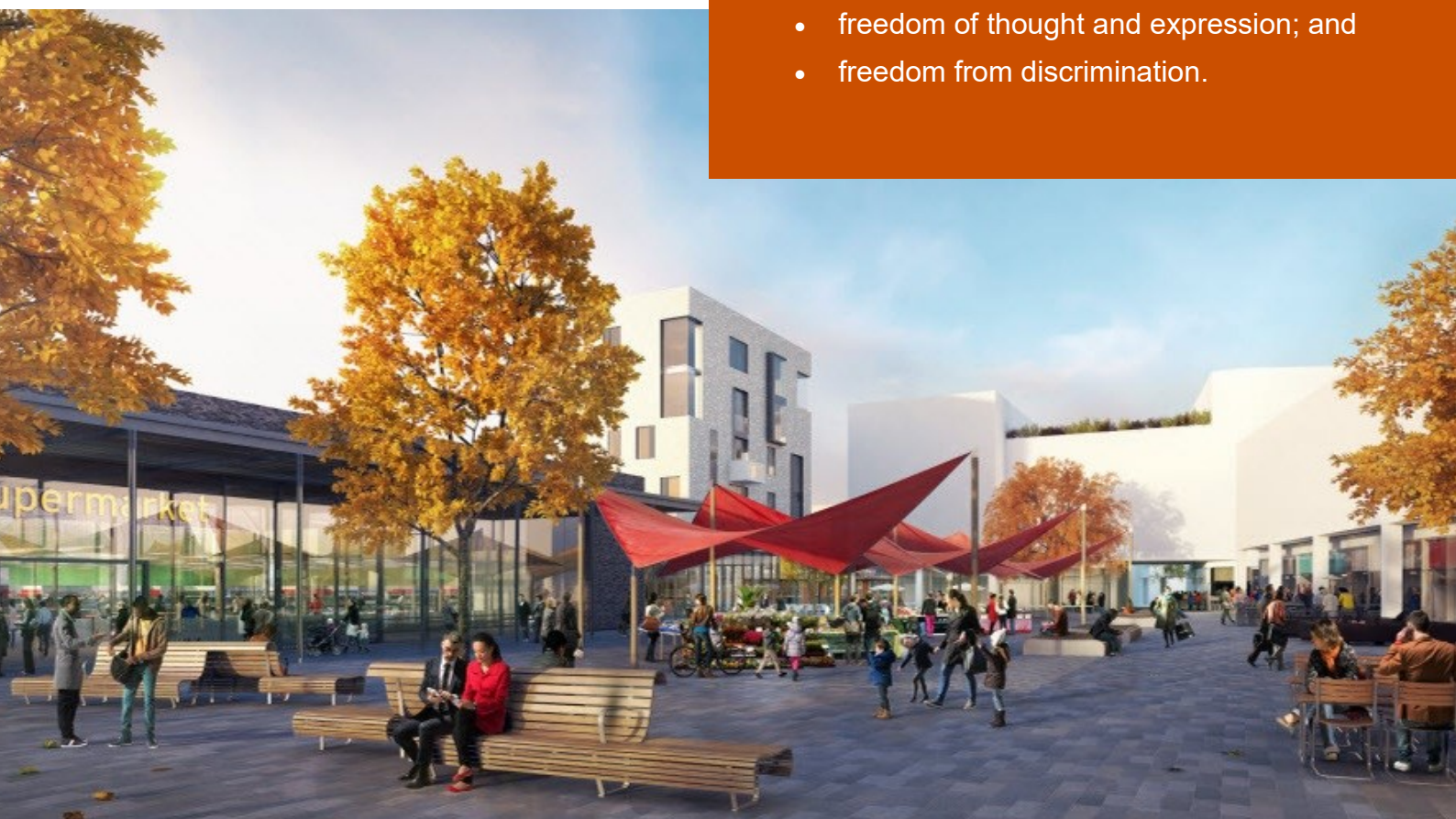



# About us

**The University is one of the world's leading academic centres. It comprises 150 faculties and departments, together with a central administration and other institutions. Our institutions, museums and collections are a world-class resource for researchers, students and members of the public representing one of the country's highest concentrations of internationally important collections.**

The University has an annual income of £2 billion. Research income, won competitively from the UK Research Councils, the European Union (EU), major charities and industry, exceeds £500 million per annum and continues to grow.

The Colleges and the University remain committed to admitting the best students regardless of their background and to investing considerable resources both in widening access and financial support. The 31 Colleges are self-governing, separate legal entities which appoint their own staff. Many academic staff are invited to join a College as a Teaching Fellow, which provides a further social and intellectual dimension. The Colleges admit undergraduate students, provide student accommodation and pastoral support and deliver small group teaching for undergraduates.

The University awards degrees and its faculties and departments provide lectures and seminars for students and determine the syllabi for teaching.

Our instinct for seeking out excellence and setting up enduring and mutually beneficial collaborations has led us to establish strategic partnerships across the globe. Whether it is the successful Cambridge-Africa Programme involving universities in Ghana, Uganda and elsewhere on the African continent; or the close association with the government of India to pursue new research in crop science; or the creation, with Germany's Max Planck Institutes, of a Cambridge-based centre for the study of ethics, human economy and social change – international partnerships are now an inextricable part of the University's make-up.

“Cambridge graduates and researchers have made – and continue to make – a colossal contribution to human knowledge and the understanding of the world around us. Their work touches on the lives and livelihoods of everyone from patients diagnosed with life-threatening diseases, to residents of areas critically affected by climate change, to children growing up in conflict zones. It has a lasting impact on our society, our economy and our culture: the world is truly a better place thanks to their efforts.”

*Stephen Toope, Vice Chancellor 2019*



# Working at the University

**Working at Cambridge you will join a diverse, talented and innovative community, with more than 23,000 students and over 16,000 staff from all walks of life and corners of the world.**

The University continually explores strategies to attract and retain the best people. It is committed to supporting its staff to achieve their best. We are a fair, diverse and inclusive society and we believe our staff are our greatest asset. There is strong commitment to developing institutional leadership and supporting and encouraging staff development at all levels.

We offer a variety of roles including academic, research, professional, managerial and support roles. We also offer extensive benefits and excellent learning opportunities within a stimulating working environment.

The University's estate is undergoing the most significant transformation in its history. Cambridge has been able to create a new science and technology campus to the west of the city centre, and is now expanding further to the north west of Cambridge including investing in affordable homes for University key workers and community facilities. Even with our continued development, the University remains within walking or cycling distance across the campus. The University is a major partner on the Cambridge Biomedical Campus and we continue to redevelop our historic city centre sites demonstrating our determination to ensure that we can offer the best facilities and opportunities for our staff and students.



## **Equality & diversity**

The University has built its excellence on the diversity of its staff and student community. We aim to be a leader in fostering equality and inclusion, and in promoting respect and a sense of belonging for all. We encourage applications from all sections of society. All appointments are made on the basis of merit. We have an Equal Opportunities Policy, along with a range of diversity groups, including the Women's Staff Network, Race Equality Network and LGBT+ Staff Network. More details are available here: <http://www.equality.admin.cam.ac.uk/>

The University has a bronze Race Equality Charter award, with a framework for improving the representation, progression and success of minority ethnic staff and students within higher education. Furthermore, the University's silver Athena swan award recognises and celebrates good practice in recruiting, retaining and promoting gender equality.

# Living in Cambridge

**Cambridge is rich in cultural diversity. From beautiful University and College buildings, museums and art galleries, quaint gardens and punts on the River Cam, to a vibrant restaurant and café scene, our employees are surrounded by the wonderful features of this unique city.**

You can find a wide-range of high street shops and 3 shopping centres, with independent alternatives at the historic market and nestled within the passageways in the city centre. You will find a cinema, bowling alley, a nightclub and various live performances at the Cambridge Leisure Park, with further entertainment options at the Corn Exchange, Arts Theatre and the ADC Theatre. Further information can be found on the [Visit Cambridge](#) website.

If you prefer the faster pace of life, London is a 45 minute train journey away. For those travelling from overseas, Stansted Airport is just 45 minutes away and Heathrow Airport under 2 hours away. The University is a short distance from a host of other attractions such as Ely Cathedral, Newmarket Races and various wildlife parks and stately homes. Cambridge is also within easy reach of the beautiful Broads and coastlines of Norfolk and Suffolk.



## Relocation Support

The University recognises the importance of helping individuals to move and settle into a new area. We provide support and guidance to those relocating internationally or domestically to take up a post at the University of Cambridge, liaising with other University offices and selected partners to ensure comprehensive relocation support is available. This includes: accommodation, childcare, schools, banking, immigration and transport. If you would like further information, please visit <https://www.accommodation.cam.ac.uk/RelocationService/>. The Shared Equity Scheme and the Reimbursement of Relocation Expenses Scheme provide financial assistance to qualifying new members of staff with the costs of relocating to Cambridge. For staff who require a Skilled Worker Visa, Global Talent Visa or Settlement (known as indefinite leave to remain) to take up employment with the University, we offer an interest free [visa loan scheme](#) for current and prospective staff (and their dependants), to help meeting the cost of obtaining a visa.

## Accommodation Service

The University Accommodation Service helps staff, students and visiting scholars who are affiliated to the University in their search for suitable accommodation in Cambridge. The dedicated accommodation team can provide access to a wide range of University-owned furnished and unfurnished properties, and has a database of private sector accommodation available for short and long-term lets. For further information and to register with this free service please visit <https://www.accommodation.cam.ac.uk/>

# What Cambridge can offer

**We offer a comprehensive reward package to attract, motivate and retain high performing staff at all levels and in all areas of work.**

The University offers a wide range of competitive benefits, from family leave entitlement, to shopping and travel discount schemes. Our generous annual leave package contributes to the positive wellbeing of our University employees. Sabbatical leave enables academics to focus on research and scholarship, whilst still maintaining their full salary. The University also has a [career break scheme](#) for academic and academic-related staff, with additional flexible working policies for all other staff.

## Pay and benefits

The University salary structure includes automatic service-related pay progression in many of its grades and an annual cost of living increase. In addition to this, employees are rewarded for outstanding contribution through a number of regular pay progression schemes. The University offers attractive pensions schemes for employees, with an additional benefit of a salary exchange arrangement providing tax and national insurance savings.



## CAMbens employee benefits

The University offers employees a wide range of competitive benefits, known as CAMbens. CAMbens offers something for everyone across a range of categories, including:

- Financial Benefits, including shopping discounts (both local and national) and a Payroll Giving scheme;
- Relocation and Accommodation Benefits, including relocation assistance and interest-free Rental Deposit Loans;
- Travel Benefits, including Cycle to Work, discounts on train season tickets and interest-free Travel to Work loans;
- Family Friendly and Lifestyle Benefits, including support with childcare and family friendly policies;
- Health and Wellbeing Benefits, including a University Staff Counselling Service, discounts at the University Sports Centre, and other local gyms, and healthcare schemes.



# What Cambridge can offer

## Family-friendly policies

The University recognises the importance of supporting its staff. We have a range of family-friendly policies to aid employees' work-life balance including a generous maternity, adoption and shared parental leave entitlement of 18 weeks full pay, and paid emergency leave for parents and carers.

Other family-friendly support includes:

Our highly regarded workplace nurseries, a childcare salary exchange scheme and a high quality holiday Playscheme may be available to help support University employees with caring responsibilities (subject to demand and qualifying criteria). Further childcare information can be found here: <https://www.childcare.admin.cam.ac.uk/>

The [Newcomers and Visiting Scholars Group](#) is an organisation within the University run by volunteers whose aim is to help newly arrived wives, husbands, partners and families of Visiting Scholars and members of the University to settle in Cambridge and give them an opportunity to meet local people. The Postdoc Academy supports the postdoctoral community within Cambridge. Further details are available here: <https://www.postdocacademy.cam.ac.uk/>

## Your wellbeing

The University's Sport Centre, Counselling Services and Occupational Health are just some of the support services available to University employees to promote their physical and mental wellbeing. The University delivers The Festival of Wellbeing annually, which is a programme of stimulating talks and activities, which aim to promote wellbeing and good mental and physical health. The University also hosts the [Cambridge Festival](#), which is a great opportunity to get your first taste of public engagement, through volunteering, supporting hands-on activities or proposing a talk.

## Development opportunities

We support new employees to settle in through various activities as well as supporting their professional and career development on an ongoing basis. Our Personal and Professional Development (PPD) team provide development opportunities for all University employees, including face-to-face sessions, online learning modules and webinars. All employees also have unlimited access to LinkedIn Learning to support their development. Both new and existing employees can undertake funded Apprenticeships, which lead to a range of vocational and professional qualifications. We offer reduced staff fees for University of Cambridge graduate courses and the opportunity to attend lectures and seminars held by University departments and institutions. A range of University training providers also offer specialist learning and development in their own areas e.g. teaching and learning, digital literacy, finance, health and wellbeing, safety.



# How to apply

Applications should be made via the University's Web Recruitment System, where you will need to register an account (if you have not already) and log in before completing the online application form.

Applications are due by **midnight (GMT) on Friday 17<sup>h</sup> January 2025** and should include:

- **A Curriculum Vitae**, including a list of publications.
- **A cover letter**, outlining your interest in the role and how your skills and experiences will complement the Japanese section and faculty
- **A representative piece of written work**, your dissertation, a recent article, or a book chapter.

Please ensure that you **upload all requested documents**, in the Upload section of the online application (Please note that if you send any additional documents, which have not been requested, we will not be able to consider these as part of your application).

Interviews are expected to be conducted in March/April 2025, subject to confirmation and change.

Please email, Professor Mickey Adolphson ([sma75@cam.ac.uk](mailto:sma75@cam.ac.uk)), if you have further queries. Questions regarding the application process should be directed to the School HR Team ([sahhr@admin.cam.ac.uk](mailto:sahhr@admin.cam.ac.uk)).